

A LOT TO LIKE  
AT A LIKEABLE PRICE.

# ALL THE FEATURES YOU WANT. INCLUDING THE PRICE.

Whether you're replacing, remodeling or building, now you can bring Andersen beauty, craftsmanship and time-tested performance into your home for less than you may expect. Andersen® 100 Series windows and patio doors are made with our patented, revolutionary Fibrex® composite material, which allows us to offer an uncommon value others can't. It's environmentally responsible and energy efficient, and it comes in durable, deep, rich colors you can't get with vinyl.



## LONG-LASTING RELIABILITY

Durable Andersen® 100 Series products come with factory-finished interiors and exteriors that never need painting and won't fade, flake, blister, chalk or peel.\*

## DEEP, RICH COLORS



Andersen® 100 Series windows come in beautiful, dark colors that will set your home apart.



Deep, rich colors, including Dark Bronze, complement virtually any architectural style.

## MADE POSSIBLE BY OUR EXCLUSIVE FIBREX® MATERIAL

Fibrex® material is more than just environmentally responsible. It's also durable and beautiful. Here's what helps make Fibrex® material so revolutionary:

- Fibrex® material is **twice as strong as vinyl**, so weathertight seals stay weathertight.
- Our unique fabrication process **blends the color with the Fibrex® material** for long-lasting\* beauty.
- It blocks thermal transfer nearly 700 times better than aluminum to help **reduce heating and cooling bills**.
- For **exceptional durability**, Fibrex® material retains its stability and rigidity in all climates.



## ENVIRONMENTALLY SMART

Andersen® 100 Series products are made with our Fibrex® composite material. It's composed of 40% reclaimed wood fiber by weight, most of which is created during the manufacture of Andersen® wood windows.



**40%**  
**reclaimed wood fiber**  
by weight.



# WHY ANDERSEN® 100 SERIES WINDOWS & DOORS ARE AN EASY CHOICE.



All Andersen® 100 Series windows and patio doors feature the performance, durability and ease of use you've come to expect from Andersen. Which means they not only provide energy efficiency, beauty and reliability today, but they'll also continue to add value to your home tomorrow and for years to come.

## REPLACEMENT

If you're thinking of replacement, think of Andersen 100 Series windows and patio doors. You'll find choices for virtually any project, and all feature energy-efficient designs that help keep energy bills to a minimum.

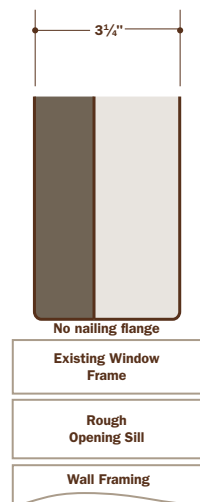

### Replacement Configuration

This frame allows for fast and easy window replacement. Install the window into your existing window frame without disturbing interior or exterior trim, which saves you time and money.

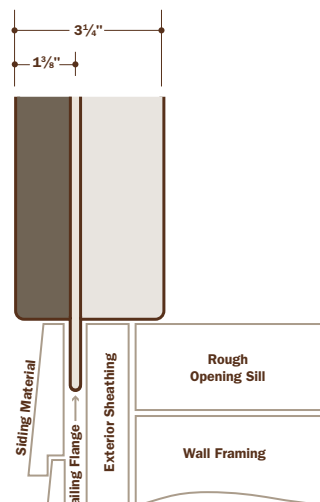

### 1 3/8" Flange Setback

The integral nailing flange makes it easy to install windows into a new opening and helps make sure the windows and doors are weathertight.

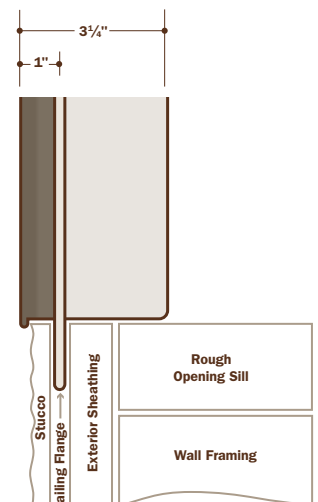

### 1" Flange Setback with Stucco Key

The integral nailing flange makes it easy to install windows into a new opening and helps make sure the windows and doors are weathertight. The stucco key eliminates gaps that can result from the natural contraction of exterior stucco.



### Custom sizes for a weathertight fit.

Andersen 100 Series windows and patio doors are available in custom sizes, which helps provide a more weathertight fit for any replacement project.

# ENERGY EFFICIENCY



## Save money by saving energy.

Andersen® 100 Series products with optional SmartSun™ glass\* meet ENERGY STAR® qualifications to help **lower your heating and cooling bills** no matter where you live. What's more, the Fibrex® material used for Andersen® 100 Series frames and sash blocks thermal transfer nearly 700 times better than aluminum.

## It pays to understand performance.

Look for the National Fenestration Rating Council® (NFRC) performance information. It's your assurance you're getting accurate energy performance ratings from a nonpartisan, nonprofit organization. Here's what the numbers mean:

**U-Factor** measures the window's insulating capability. The lower the value, the less heat is lost through the entire product.

**Visible Transmittance** refers to how much visible light comes through a product. The higher the number, the better.

**Solar Heat Gain Coefficient (SHGC)** measures how well a product blocks heat from the sun. The lower the number, the more it helps reduce air conditioning bills.

Visit [andersenwindows.com/100series](http://andersenwindows.com/100series) for details. Click on "Windows" or "Doors" underneath the Andersen logo, then click on the NFRC link on the right-hand side.

# RELIABILITY

## Easy operation for years to come.\*\*

All Andersen 100 Series products are **tested to the extreme** to deliver years of smooth, reliable operation.\*\*

## Take comfort in superior weather resistance.

Our weather-resistant construction **seals out drafts, wind and water** so well, you can relax in comfort whatever the weather. We carefully select weatherstripping to match each style of window and door to make sure you enjoy superior comfort and reliability.



## Quality so solid, the warranty is transferable.\*\*

Most other window and door warranties end when a home is sold, but Andersen 100 Series products' 10-year coverage transfers from each homeowner to the next. And, because it's not prorated, the coverage offers **full benefits, year after year, owner after owner**. So it can add real value when you decide to sell your home.

## Never needs painting.

Andersen® 100 Series windows and doors **won't fade, flake, blister, chalk or peel,\*\*** no matter what the climate.

# BEAUTY

## Virtually seamless corners.

To give your windows, patio doors and your home a beautiful, clean look, Andersen 100 Series products feature virtually seamless corners.



100 Series corner seam



Vinyl corner seam

## Five colors for beautiful curb appeal.

From White and Sandtone to deep, rich Cocoa Bean, Dark Bronze and Terratone® colors, 100 Series windows and doors complement any home and any replacement project.

## Improve your view with TruScene® insect screens.

With **over 50% more clarity** than conventional insect screens, optional TruScene® insect screens give you beautifully unobstructed views. They let more sunlight and fresh air into your home while keeping some of the smallest insects out.<sup>†</sup>

# CHOOSE THE WINDOWS, DOORS & OPTIONS THAT ARE RIGHT FOR YOU.

## WINDOW & DOOR TYPES

Building an energy-efficient home doesn't mean you have to restrict your dreaming. Andersen® 100 Series windows and doors come in styles, shapes and even custom sizes to create the look you want.



### SINGLE-HUNG WINDOWS

This style features a stationary upper sash that is also available with an arched top to enhance the look of your home.



### CASEMENT & AWNING WINDOWS

Both styles open with a simple turn of a handle and can also be ordered as stationary windows.



### GLIDING WINDOWS

These units have one stationary sash and one that opens. A three-sash configuration, where two sash glide past a fixed center sash, is also available.



### GLIDING PATIO DOORS

Patio doors feature one stationary panel and one that glides smoothly on adjustable rollers. They feature a multi-point locking system for enhanced security, and an optional exterior keyed lock for convenience. For more character, consider adding Andersen® 100 Series sidelight windows on each side of your door and a transom window on top.



### SPECIALTY WINDOWS

Archtop, Springline™, Circle Top™, quarter circle, full circle, rectangle and other geometric shapes are available to complement your home's architecture. Curved specialty windows are not available in custom sizes.



Available in custom sizes to fit all projects, including replacement.

## GLASS

Choose the right glass to maximize performance.

### SMARTSUN™ GLASS

Low-E SmartSun™ glass is the most energy-efficient glass we have ever offered. It rejects unwanted solar heat to help reduce cooling costs and blocks 95% of UV rays that can cause your home furnishings to fade — all while providing a clear view.

### LOW-E GLASS

Energy-efficient Low-E glass is available on all Andersen® 100 Series products, and can help reduce energy bills in any climate.

### DUAL-PANE GLASS

Dual-pane glass is available for projects where codes allow its use.\*

### PERFORMANCE COMPARISON OF ANDERSEN® 100 SERIES GLASS OPTIONS\*\*

	SmartSun™	Low-E	Dual Pane
U-Factor (Lower is better)	0.28	0.29	0.41
Solar Heat Gain Coefficient (Lower is better)	0.19	0.28	0.53
Visible Light Transmittance (Higher is better)	0.43	0.48	0.55
UV Rays Blocked by Glass (Higher is better)	95%	83%	38%

### PATTERNED GLASS

Our patterned glass is ideal in bathrooms, entryways, offices and other areas where you want to let light into your home while obscuring the vision of people outside. It delivers all the benefits of Low-E glass and can also be ordered with Low-E SmartSun™ glass.



Obscure



Cascade



Reed



Fern

## HARDWARE

You get attractive hardware that performs reliably for years.†

### WINDOW HARDWARE

All window hardware is white to match the interior of your windows.



**Casement** and **awning** hardware folds down so it doesn't interfere with window treatments.



**Single-hung** and **gliding windows** feature hardware that automatically locks when windows are closed. A Window Opening Control Device is available, which limits raising the sash to less than 4" when the window is first opened.



Optional single-hung lift/gliding window handle

### PATIO DOOR HARDWARE

Tulsa and Afton hardware options are available. Tulsa hardware exterior handles match the door's exterior color, while interior handles are white to match the interior. Afton hardware has the same finish inside and out, and is available in bright brass, antique brass, black and satin nickel finishes. Also available, an optional auxiliary foot lock that secures the gliding panel in the track. It provides an extra measure of security when the door is in a locked position.

#### TULSA HARDWARE



Exterior Handle  
(Shown in Dark Bronze)

Interior Handle

#### AFTON HARDWARE



Exterior Handle

(Shown in Satin Nickel)

Interior Handle

## COLOR

Choose the right color to enhance the beauty of your home.



Dark Bronze



Cocoa Bean



Terratone®



Sandtone

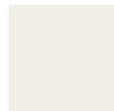

White

### EXTERIOR COLORS

Andersen® 100 Series products come in five exterior colors, including Dark Bronze and Cocoa Bean — colors that are darker and richer than most vinyl windows.

### WHITE INTERIORS

Andersen® 100 Series windows and doors feature an attractive matte white finish inside. This gives you the ability to select your favorite exterior color without compromising options for interior decoration.

Printing limitations prevent exact color duplication. See your Andersen dealer for actual color samples.

## GRILLES

Customize the look of your windows and doors with Andersen® grilles.

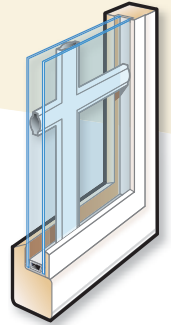

Andersen® 100 Series products are available with **Finelight™** grilles-between-the-glass that make window and patio door glass easy to clean. They have an elegant, sculpted profile, plus they offer a **two-sided color scheme**, allowing you to have grilles that match not only the white interior but also your exterior color choice.

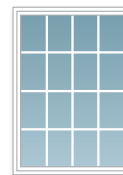

Colonial



Modified  
Colonial



Prairie A



Short  
Fractional



Tall  
Fractional

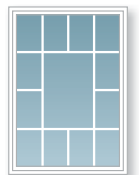

Victorian



Renaissance



Sunburst

### SPECIFIED EQUAL LIGHT

Any number of same-size rectangles across or down. Some limitations apply.



(2 x 2)



(2 x 4)



(2 x 1)



(1 x 3)



# IMPROVING THE VIEW OUTSIDE.

## Respect for the environment is nothing new at Andersen.

For more than a century, it's been part of who we are. Our commitment to recycle and reclaim materials began simply because it was good business. Now it's part of our commitment to sustainability and responsible stewardship of all our resources. Andersen is committed to providing you with long-lasting, energy-efficient windows and doors.



Andersen makes windows and doors that meet **ENERGY STAR**<sup>®</sup> performance requirements in all 50 states. Andersen Corporation has earned the 2011 ENERGY STAR<sup>®</sup> Partner of the Year award.



Andersen is a charter member of the **U.S. Green Building Council** and a strong supporter of its LEED<sup>®</sup> (Leadership in Energy and Environmental Design) Green Building Rating System.



Andersen was the first window and door manufacturer with **Green Seal**<sup>™</sup> certified products. Please visit our web site at [www.andersenwindows.com](http://www.andersenwindows.com) for a list of certified products.

WINDOWS • DOORS  
**Andersen**<sup>®</sup> 

*Come home to Andersen.<sup>®</sup>*

[andersenwindows.com/100series](http://andersenwindows.com/100series)

